

Penn Parts Schematic

5500ss

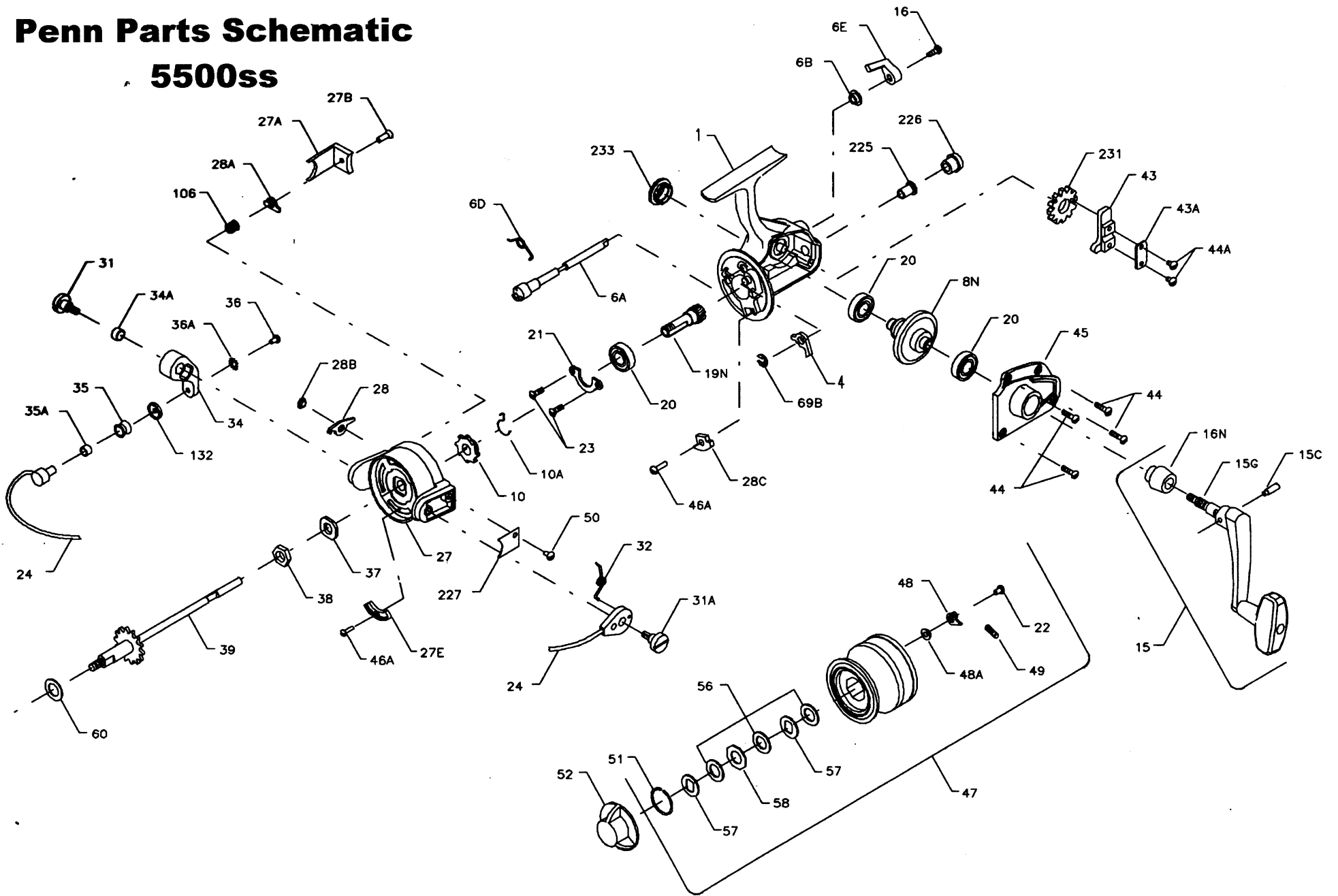

Penn Reel Parts list for:

Model: 5500SS

KEY PART			KEY PART		
NO	NO.	DESCRIPTION	NO	NO.	DESCRIPTION
1	1P-5500	HOUSING	35	35-704	LINE ROLLER
4	4N-4400	DOG (f/new model w/c-clip on dog post)	35A	35A-704	LINE ROLLER BUSHING
4	4-450	DOG (f/older models)	36	36-750	BAIL STUD SCREW
6A	6A-450	ECCENTRIC	36A	36A-750	LOCK WASHER
6B	6B-750	ECCENTRIC LINER	37	37-450	ROTOR WASHER
6D	6D-710	ECCENTRIC SPRING	38	38-550	ROTOR NUT
6E	6E-750	ECCENTRIC LEVER	39	39N-5500	SPOOL SHAFT
8N	8N-5500	MAIN GEAR	43	43N-5500	CROSSWIND BLOCK
10	10N-4400	RATCHET (f/new model w/c-clip on dog post)	43A	43A-550	CROSSWIND BLOCK PLATE
10	10-440	RATCHET (f/older models)	44	44-704	COVER SCREW (4 REQ.)
10A	230N-5500	ANTI REVERSE SPRING	44A	22-750	CROSSWIND BLOCK SCREW (2 4REQ.)
15	15-5500	HANDLE (COMPLETE)	45	45-5500	HOUSING COVER
15	15C-650	HANDLE PIVOT SCREW	46A	46A-704	SCREW (2 REQ.)
15G	15G-5500	HANDLE PIVOT SCREW	47	47-5500	SPOOL (COMPLETE)
16	16-910	ECCENTRIC SCREW	48	48-750	CLICK TOUNGE
16N	16-5500	HANDLE COLLAR	48A	48A-750	CLICK TOUNGE WASHER
19A	19A-550	PINION SPACER	49	49-710	CLICK TOUNGE SPRING
19N	19N-5500	PINION	50	50-712	BAIL SPRING COVER SCREW
20	20-722	BALL BEARING	51	51-710	RETAINING RING
21	21-450	BEARING COVER	52	52-550	DRAG KNOB
22	22-750	SPOOL CLICK SCREW	56	56-710	DRAG WASHER-HT 100 (3 REQ.)
23	23-750	BERING COVER SCREW (2 REQ.)	57	57-710	METAL KEYED WASHER (2 REQ.)
24	24-5500	BAIL WIRE	58	58-710	METAL WASHER (OCTAGON)
27	27-5500	ROTOR	60	60-550	THRUST WASHER (TEFLON)
27A	27A-5500	BAIL TRIP COVER	69B	69B-4400	RETAINING RING
27B	27B-420	ROTOR END SCREW	106	106-5500	ROTOR END SPRING
27E	27E-5500	BALANCE WEIGHT	132	132-450	ROLLER WASHER
28	28-5500	TRIP LEVER	225	225-5500	CROSSWIND SHAFT BUSHING
28A	28A-440	CAM LEVER	226	226-5500	BUSHING CAP SCREW
28B	28B-5500	TRIP LEVER BUSHING	227	227-440	BAIL SRPING
28C	28C-440	TRIP CAM	231	231N-5500	CROSSWIND GEAR
31	31-550	BAIL ARM SCREW	233	233-440	BERING COVER
31A	31A-450	TRIP ARM SCREW	**	300-5500	POWER HANDLE
32	32-440	BAIL SPRING			
34	34-450	BAIL ARM			
34A	34A-550	BAIL ARM BUSHING			

NOT SHOWN

NOTE: Many of www.pennparts.com schematics include changes that were either made by Penn, or errors found and corrected by our parts dept.