

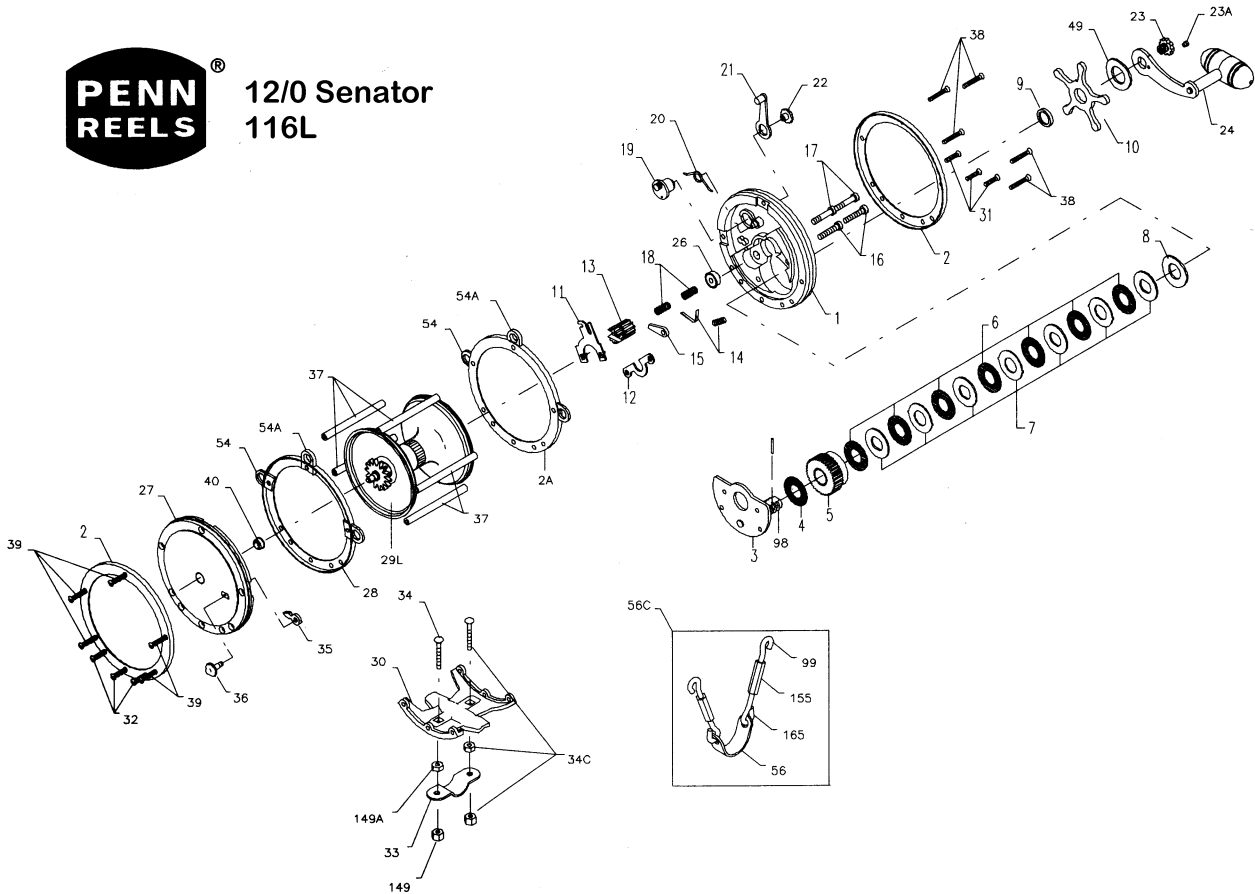

12/0 Senator 116L



Penn Reel Parts list for:

Model: 116L

KEY	PART		KEY	PART	
NO	NO.	DESCRIPTION	NO	NO.	DESCRIPTION
1	1-116	RIGHT SIDE PLATE	27	27-116	LEFT SIDE PLATE
2	2-116-O	OUTER RING (2 REQ.)	28	28-116-I	INNER LEFT SIDE RING
2A	2-116-I	INNER RING SIDE RING	29L	29L-116	SPOOL
3	3-116	BRIDGE W/ SLEEVE	30	30-116	STAND
4	4-116	FIBER WASHER	31	39-12	R.S. STAND SCREW
5	5-116	MAIN GEAR	32	32-21	L.S. STAND SCREW
6	6-116	DRAG WASHER (7 REQ.)	33	33-116	ROD CLAMP
7C	7c-116	METAL DRAG WASHER SET	*	33-130ST	RINGED ROD CLAMP (OPTIONAL)
8	8-116	TENSION SPRING	34	34-116	CLAMP SCREW
9	9-116	SPACING SLEEVE	34C	34c-116	CLAMP SCREW W/ NUTS
10	10-116	STAR DRAG WHEEL	35	35-115	CLICK TONGUE
11	11-116	ECCENTRIC JACK	36	36-115	CLICK BUTTON
12	12-116	PINION YOKE	37	37-116	FRAME POST (8 REQ.)
13	13-116	PINION	38	39-13	RIGHT/LEFT SIDE POST SCREW (8 REQ.per side)
14	14-116	DOG SPRING	40	26-116	LEFT SIDE BEARING
15	15-116	DOG	49	49-116	HANDLE SPACER
16	16-114	LOWER BRIDGE SCREW (2 REQ.)	54	54-114	HARNESS LUG (2 REQ.)
17	17-114	UPPER BRIDGE SCREW (2 REQ.)	54A	54-116	HARNESS LUG (2 REQ.)
18	18-114	CLUTCH SPRING (2 REQ.)	56	56-226	ROD BRACE
19	19-115	ECCENTRIC	56C	56C-116	ROD BRACE (COMPLETE)
20	20-114	ECCENTRIC SPRING	98	98-116	GEAR SLEEVE
21	21-116	ECCENTRIC LEVER	99	99-116	HOOK SCREW L.H. THREAD (2 REQ.)
22	22-60	ECCENTRIC SCREW	149	149-116L	HEX NUT (2 REQ.)
23	23-116	HANDLE SCREW	149A	149-116H	CLAMP NUT (2 REQ.)
23A	110-60	HANDLE LOCK SCREW	155	155-116	TURN BUCKLE (2 REQ.)
24	24-116	HANDLE	165	165-116	HOOK SCREW L.H. THREAD (2 REQ.)
26	26-116	RIGHT SIDE BEARING	<i>*Not Shown</i>		

NOTE: Many of www.pennparts.com schematics include changes that were either made by Penn, or errors found and corrected by our parts dept.